



Capital Budget Community Meeting on Future School Facility Projects - Eastern Loudoun Area Focus

June 23, 2022

LCPS Capital Budget Overview



TABLE OF CONTENTS

LOUDOUN COUNTY PUBLIC SCHOOLS - EXISTING & PLANNED SCHOOLS	3
CAPITAL PLANNING & BUDGETING - EXECUTIVE SUMMARY	9
SCHOOL BOARD ADOPTED 2023 – FY 2028 CAPITAL IMPROVEMENT PROGRAM (CIP) & FY 2029 – FY 2052 CAPITAL PROJECTS FORECAST	29
New Construction	37
Other Projects	43
Capital Renewals & Alterations	51
Previously Approved/Appropriated Projects	79
SCHOOL BOARD ADOPTED FY 2023 – FY 2028 CAPITAL ASSET PRESERVATION PROGRAM (CAPP)	89
LAND ACQUISITION	111
BUILDING CAPACITY	115
FACILITY ANALYSIS	127
Eastern Loudoun Planning District	131
Ashburn Planning District	137
Dulles North Planning District	143
Dulles South Planning District	149
Central Loudoun Planning District	157
Western Loudoun Planning District	165
GLOSSARY OF TERMS.....	173
SUPPLEMENTAL LOUDOUN COUNTY PUBLIC SCHOOLS INFORMATION	
APPENDIX A: September 30 Enrollment History	185
September 30, 2021 Enrollment by School	187
APPENDIX B: Student Assignments Outside of Geographic Planning District.....	189
APPENDIX C: Student Generation Factors	191
APPENDIX D: Building Location Map	193
School Facilities, 2021-2022 School Year	194
APPENDIX E: 2022-2023 Schools by Geographic Planning District and High School Cluster	199

LCPS Capital Budget

Capital Improvement Program (CIP)

Provides six-year student enrollment projections for division and individual schools with an adopted attendance zone

Involves acquisition, development, construction, and/or renovation of facilities, infrastructure, and capital equipment

- Short-Term CIP (Fiscal Years 1-6)
 - Years 1 and 2 Most Critical for Project Identification and Funding
 - Individual Project Pages
- Medium-Term CIP (Fiscal Year 7-10)
 - Corresponds to Board of Supervisors 10-Year Capital Needs Assessment (CNA)
- Long-Term Outlook (Years 11-30)

Capital Asset Preservation Program (CAPP)

Involves repair of major facility components and systems, including repair by replacement (e.g., electrical, plumbing, roofing, HVAC, structural)

- Fiscal Years 1-6
 - Project Specific Detail Provided by Component/System and by Individual School

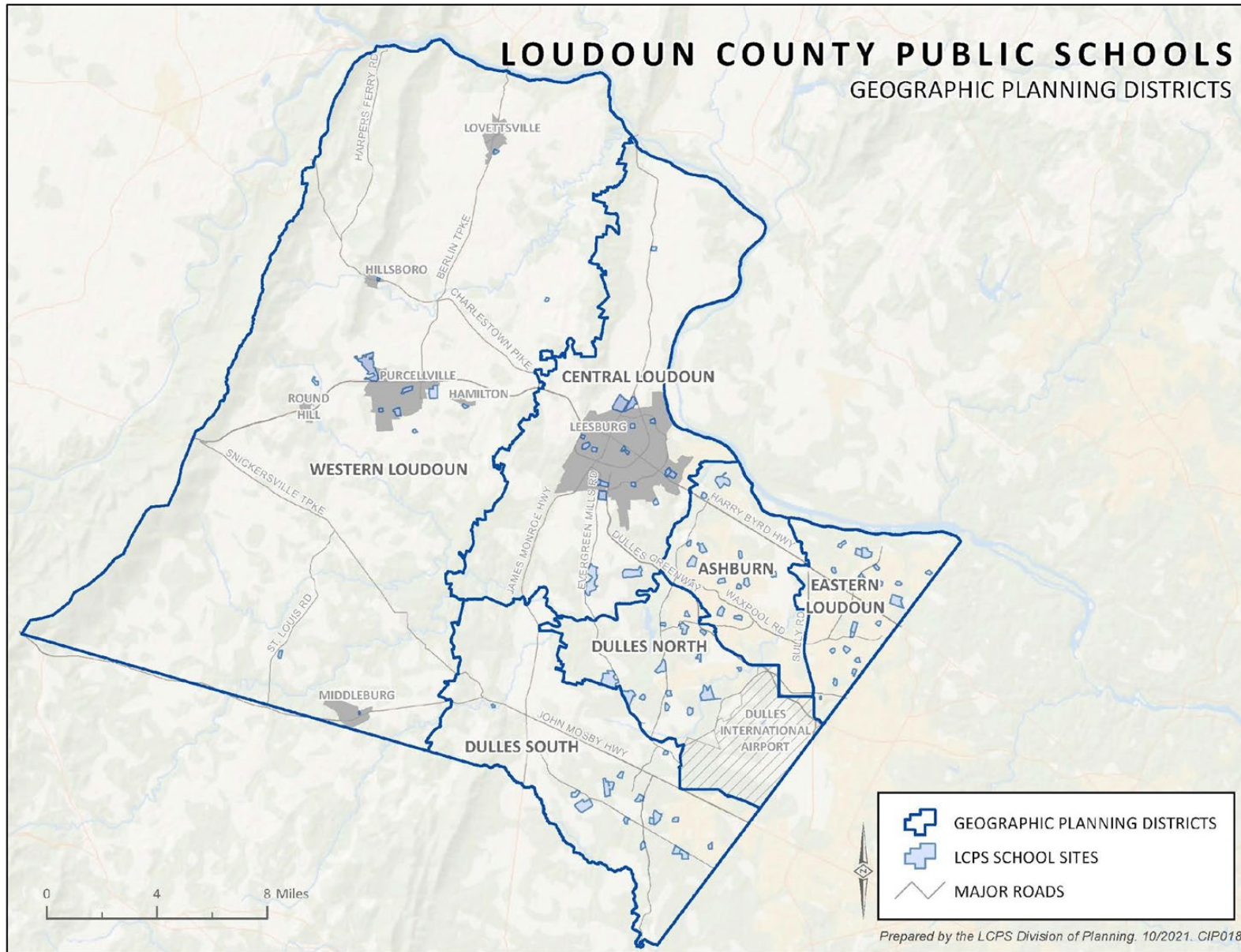

EASTERN LOUDOUN GEOGRAPHIC PLANNING DISTRICT

DOMINION HIGH SCHOOL CLUSTER

Dominion High School
Seneca Ridge Middle School
Horizon Elementary School
Lowes Island Elementary School
Meadowland Elementary School
Sugarland Elementary School

PARK VIEW HIGH SCHOOL CLUSTER

Park View High School
Sterling Middle School
Forest Grove Elementary School
Guilford Elementary School
Rolling Ridge Elementary School
Sterling Elementary School
Sully Elementary School

POTOMAC FALLS HIGH SCHOOL CLUSTER

Potomac Falls High School
River Bend Middle School
Algonkian Elementary School
Countryside Elementary School
Potowmack Elementary School

Facility Analysis

LCPS Planning District Detail

Provides Map of All School Locations with District and Approved (Unbuilt) Residential Development

Individual School Detail

Provided by LCPS Planning District, Includes Base Building Capacity, Current Year Enrollment, Six Years of Projected Enrollment

Eastern Loudoun Planning District
Approved, Unbuilt Residential Development
as of September 2021

SFD - Single Family Detached SFA - Single Family Attached MF - Multifamily

Residential Development	Approved Residential Units				Potential LCPS Students			% Complete, as of 9/2021
	SFD	SFA	MF	Total	Elementary School	Middle School	High School	
BELFORT PARK DRIVE TOWNHOMES	0	20	0	20	4	2	3	0%
DULLES TOWN CENTER	0	0	1230	1230	175	97	134	0%
KINCORA VILLAGE	0	0	2600	2600	281	157	216	24%
MOUNT STERLING	0	74	144	218	36	20	28	0%
STERLING MEADOW	0	0	166	166	24	13	18	0%
THE HUB	0	0	1265	1265	180	100	138	0%
WATERSIDE	0	0	2505	2505	355	198	273	0%
Planning District Total, as of September 2021	0	94	7910	8004	1054	588	810	

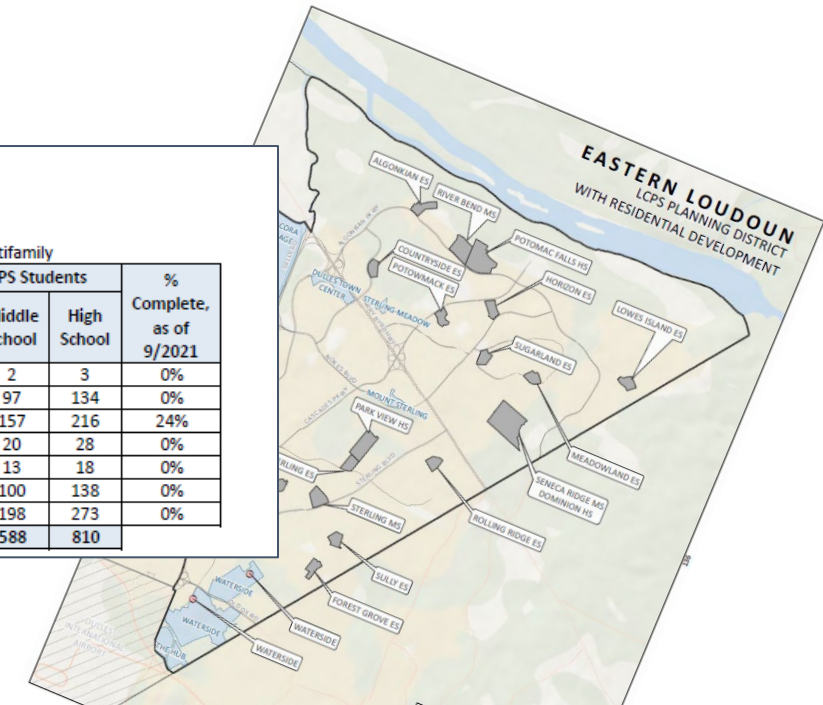

HIGH SCHOOL SUMMARY: EASTERN LOUDOUN

General Planning District Description
North/East of Route 28 (Sully Road), South of the Potomac River, West of Fairfax County

FY 2023 - FY 2028 CIP PLANNING PERIOD

HIGH SCHOOLS	2021-22 BASE CAPACITY	30-Sep-21 ACTUAL ENROLLMENT	2022-23 SCHOOL YEAR PROJECTION			2023-24 SCHOOL YEAR PROJECTION			2024-25 SCHOOL YEAR PROJECTION			2025-26 SCHOOL YEAR PROJECTION			2026-27 SCHOOL YEAR PROJECTION			2027-28 SCHOOL YEAR PROJECTION		
			ENROLL	SPACE	UTILIZE	ENROLL	SPACE	UTILIZE	ENROLL	SPACE	UTILIZE	ENROLL	SPACE	UTILIZE	ENROLL	SPACE	UTILIZE	ENROLL	SPACE	UTILIZE
DOMINION HS ^A	1793	1481	1535	258	86%	1593	200	89%	1642	151	92%	1596	197	89%	1522	271	85%	1436	357	80%
PARK VIEW HS ^B	1518	1409	1526	(8)	101%	1637	(119)	108%	1689	(171)	111%	1671	(153)	110%	1645	(127)	108%	1581	(63)	104%
POTOMAC FALLS HS ^C	1565	1622	1661	(96)	106%	1702	(137)	109%	1698	(133)	108%	1697	(132)	108%	1615	(50)	103%	1561	4	100%
	4876	4512	4722	154		4932	(56)		5029	(153)		4964	(88)		4782	94		4578	298	
WILLIAM OBEDIAH ROBEY HS ^{B, D}	20		60			60			80			80			100			100		

A - AN APPLICATION FOR A MILITARY SCIENCE PROGRAM AT DOMINION HS HAS BEEN SUBMITTED BUT IS NOT UNDER ACTIVE CONSIDERATION BY THE MILITARY; PROGRAM EXPANSION IN VIRGINIA IS NOT CURRENTLY PLANNED.

B - AN ADDITION IS PROPOSED AT PARK VIEW HS/WILLIAM OBEDIAH ROBEY HS TO BE COMPLETE BY THE START OF THE 2025-26 SCHOOL YEAR.

C - THE 2021-22 BASE CAPACITY FOR POTOMAC FALLS HS REFLECTS TWO (2) MODULAR CLASSROOMS ON SITE; WITHOUT THE MODULAR CLASSROOMS, CAPACITY AT POTOMAC FALLS HS WOULD BE 1523.

D - WILLIAM OBEDIAH ROBEY HS IS CO-LOCATED WITHIN PARK VIEW HS.

Eastern Loudoun: FY 2023 CAPP

Electrical Projects

Countryside ES, Dominion HS, Meadowland ES

HVAC Projects

Guilford ES, Horizon ES, River Bend MS, Sully ES

Plumbing Projects

Algonkian ES, Countryside ES, River Bend MS, Sterling ES

Resurfacing Projects

Meadowland ES, Park View HS, Potomac Falls HS, Potowmack ES,
River Bend MS, Sully ES

Roofing Projects

Horizon ES, Lowes Island ES

Structure Repair Projects

Countryside ES, Potomac Falls HS, River Bend MS, Seneca Ridge MS,
Sterling MS

Eastern Loudoun: FY 2023 – FY 2028 CIP

Capital Renewal & Alteration Projects

- Fine Arts Storage Improvements, Secondary Schools
- High School Baseball/Softball Press Boxes
- High School Practice Fields – Lighting & Synthetic Turf
- High School Tennis Court Lighting
- High School Weight Room Expansions, Dominion HS & Potomac Falls HS
- Modular Classroom Removal
- Privacy Space Conversions
- River Bend MS Entrance/Driveway
- Safety Security Improvements
- School Walking Tracks,
Algonkian ES, Countryside ES, Guilford ES, Rolling Ridge ES, Sterling ES, Seneca Ridge MS
- Unified Communication Systems Replacement

Eastern Loudoun: FY 2023 – FY 2028 CIP

- Student Welcome Center Addition at Sterling ES*, Fall 2023
- Potomac Falls HS Weight Room Expansion*, Fall 2022
- Park View HS Ticket Booth & Concession Replacement*,
Location Under Review with Current Study - TBD
- Park View HS/W.O. Robey HS Addition & Improvements,
Fall 2026
- School Security Improvements, Multi Year (2019-2024)

* Previously Appropriated Projects

LOUDOUN COUNTY PUBLIC SCHOOLS
STUDENT WELCOME CENTER AND CLASSROOM ADDITION AT STERLING ES



VIEW ON WELCOME CENTER ENTRY FROM EAST

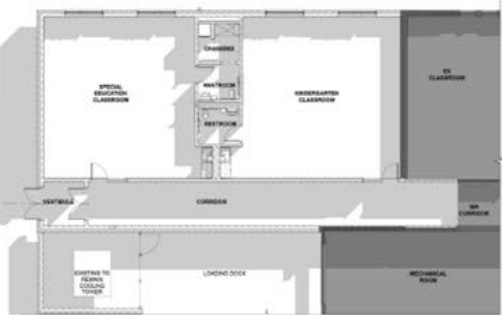

FLOOR PLAN

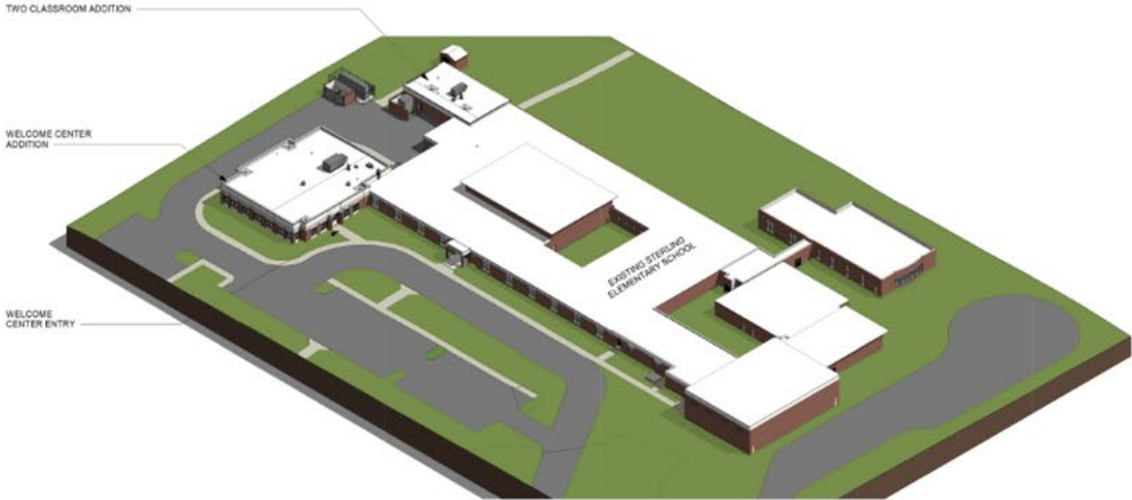

AXONOMETRIC SITE PLAN

JUNE 20, 2022

POTOMAC FALLS HIGH SCHOOL WEIGHT ROOM EXPANSION

JUNE 16, 2022



EXTERIOR VIEW



INTERIOR VIEW

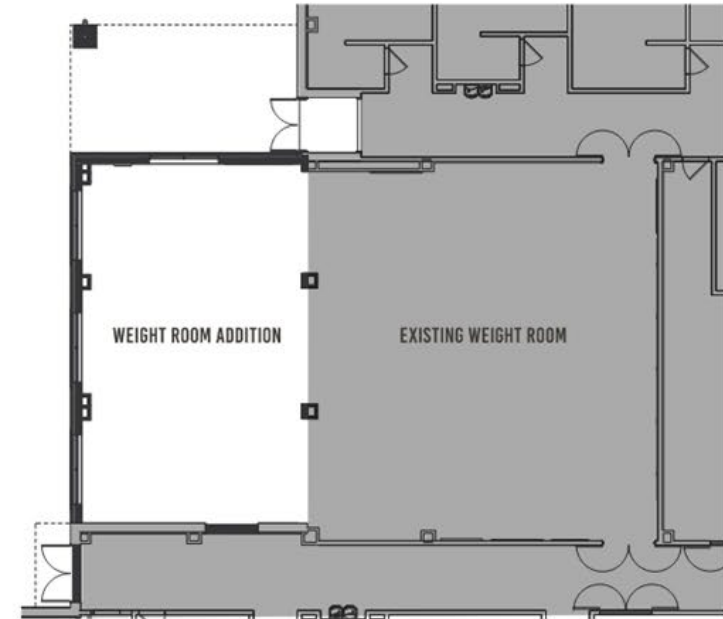

MAIN LEVEL PLAN



Park View High School

Capital Budget Community Information Meeting
June 23, 2022

© 2022. All rights reserved. Loudoun County Public Schools

Park View High School Renovations

(Slide from March 16, 2022 Park View High School Staff/Public Meeting)

**Planned
Renovations**

\$42 Million

Park View HS/W.O. Robey HS Project Budget Analysis			
Component	Total Amount	FY 2023	FY 2024
		Design	Construction
Projects Combined from Existing Approved CIP/CRP Budget:			
Press Boxes (2)	\$ 645,000	\$ 65,000	\$ 580,000
Tennis Court Lighting	\$ 400,000	\$ 40,000	\$ 360,000
Artificial Turf Practice Field	\$ 2,825,000	\$ 225,000	\$ 2,600,000
Practice Field Lights	\$ 400,000	\$ 40,000	\$ 360,000
Secure Vestibule	\$ 3,470,000	\$ 65,000	\$ 3,405,000
Subtotal	\$ 7,740,000	\$ 435,000	\$ 7,305,000
New Requests:			
Fine Arts Storage Improvements	\$ 2,045,000	\$ 205,000	\$ 1,840,000
Ticket Booth	\$ 150,000	\$ 60,000	\$ 90,000
Other Renovations	\$1,400,000	\$ 140,000	\$ 1,260,000
Park View HS Addition	\$9,000,000	\$1,000,000	\$8,000,000
W.O. Robey HS Addition	\$ 21,720,000	\$ 2,070,000	\$19,650,000
Subtotal	\$ 34,315,000	\$ 3,475,000	\$ 30,840,000
Grand Total	\$ 42,055,000	\$ 3,910,000	\$ 38,145,000

Support Services staff met with Park View High School and William Obediah Robey High School staffs in May 2021 to discuss capital and non-capital needs related to operations in the facility. Examples of “other” project related needs include but are not limited to:

Additional conference space

Small meeting space for student testing, IEP, administrative staff meetings, and teacher translators

Relocation of certain administrative staff to improve the visitor experience

Supply and storage for parent liaison

Office space accommodations for additional Student Services staff such as Psychologists and Social Workers

Reconfiguration of media center spaces

English Learners, Math, English, Social Science and World Languages work room reconfiguration

Art teacher office space reconfiguration

Repairs to auditorium restrooms and dressing rooms

Repairs to Auxiliary Gym finishes (tile walls and floors)

School Store reconfiguration

Repurpose/reconfiguration of the Career & Technical Education (CTE) space

Park View High School

Summer 2022 Projects Include:

- Ceiling Tile Replacement, 2nd Floor
- Bathroom Repairs, 2nd Floor
- Wall Tile Coating, 2nd Floor
- Contracted Painting
- Track Resurfacing
- Tennis Court Resurfacing
- Kitchen A/C

Park View HS Ticket Booth & Concession Replacement Project,
Location Under Review with Current Study

School Facility Replacement Criteria (Considerations)

- Age and Infrastructure Conditions
- Pedagogical Appropriateness
- Logistics (Swing Space)

Renovation vs Replacement Feasibility Study Process

- Perform comprehensive existing site and building analysis
- Develop multiple replacement and renovation options
- Receive feedback on preferred options
- Refine preferred options
- Develop preliminary construction schedules and cost estimate
- Finalize report
- Deliver recommendations to school board



Park View High School

Capital Budget Community Information Meeting
June 23, 2022

Existing Site Analysis Takeaways

- PVH is 40 acres vs typical 50-60 acre high school site
- Potential use of adjacent Sterling ES site for athletic field
- Potential replacement of stadium and bus parking

Existing Building Analysis Takeaways

- Load bearing walls minimize flexibility during renovation
- Low floor to floor heights
- Minimal natural light into classrooms
- Auditorium does not meet current standard



ENLARGED SITE PLAN



Park View High School

Capital Budget Community Information Meeting
June 23, 2022

© 2022. All rights reserved. Loudoun County Public Schools

New Building Option

- Preference for a concept that accommodates all athletics grouped together on the existing PVH site

Renovation Option

- Preference for concept that minimizes impact to kids during addition/renovation
- Preference for concept that builds new or renovates all spaces
- Preference for concept that meets all requirements of Ed Spec (with few exceptions) and transforms building into 21st century learning environment

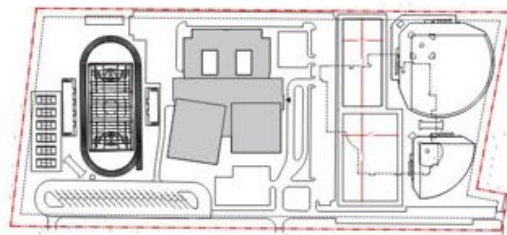

NEW BUILDING OPTION-1A

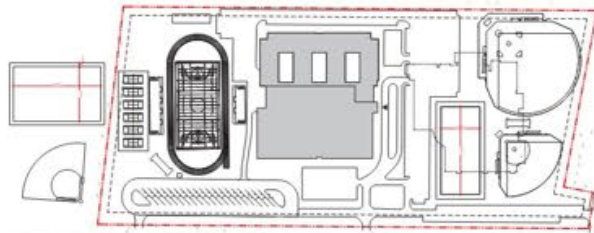

NEW BUILDING OPTION-1B

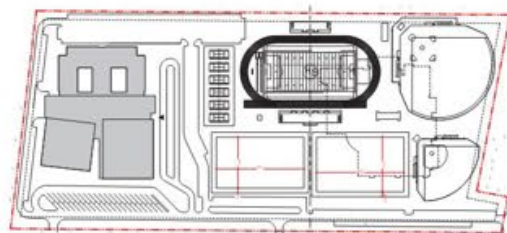

NEW BUILDING OPTION-2A

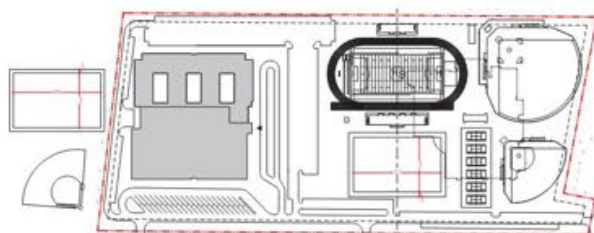

NEW BUILDING OPTION-2B

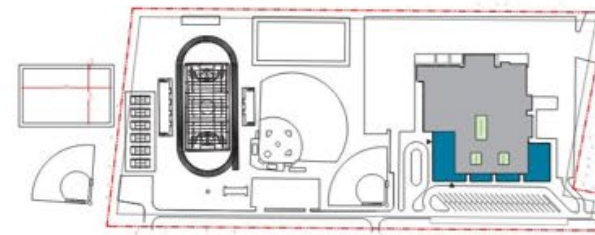

RENOVATION OPTION-1

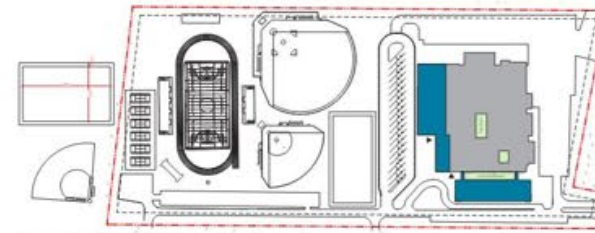

RENOVATION OPTION-2

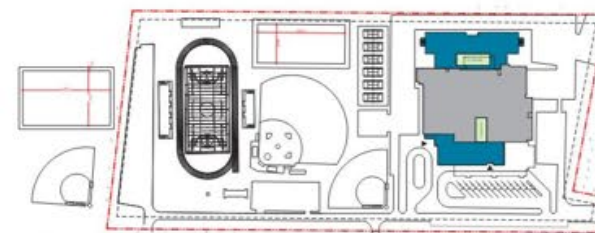

RENOVATION OPTION-3



Park View High School

Capital Budget Community Information Meeting
June 23, 2022

Design Considerations

- Full size practice field on adjacent Elementary School site

Phasing Considerations

- Minimal impact to stadium/athletics (tennis courts relocated)
- Phased-occupied addition/renovation of existing building for approximately 3 years
- No Auditorium for approximately 1 year



RENOVATION OPTION-3 SITE PLAN



Park View High School

Capital Budget Community Information Meeting
June 23, 2022

© 2022. All rights reserved. Loudoun County Public Schools



Front Entrance Before



Front Entrance After



Park View High School

Capital Budget Community Information Meeting
June 23, 2022

© 2022. All rights reserved. Loudoun County Public Schools



Front Entrance Before



Front Entrance After (Proposed Rendering)



Park View High School

Capital Budget Community Information Meeting
June 23, 2022

© 2022. All rights reserved. Loudoun County Public Schools



Corridor Before



Corridor After



Park View High School

Capital Budget Community Information Meeting
June 23, 2022

© 2022. All rights reserved. Loudoun County Public Schools



Library Before



Library After



Park View High School

Capital Budget Community Information Meeting
June 23, 2022

© 2022. All rights reserved. Loudoun County Public Schools

Design Considerations

- All athletics fit within existing PVH site and are grouped together

Phasing Considerations

- Minimal to no impact of existing school facility and traffic flow until new building is open
- No stadium/baseball field for approximately 3 years

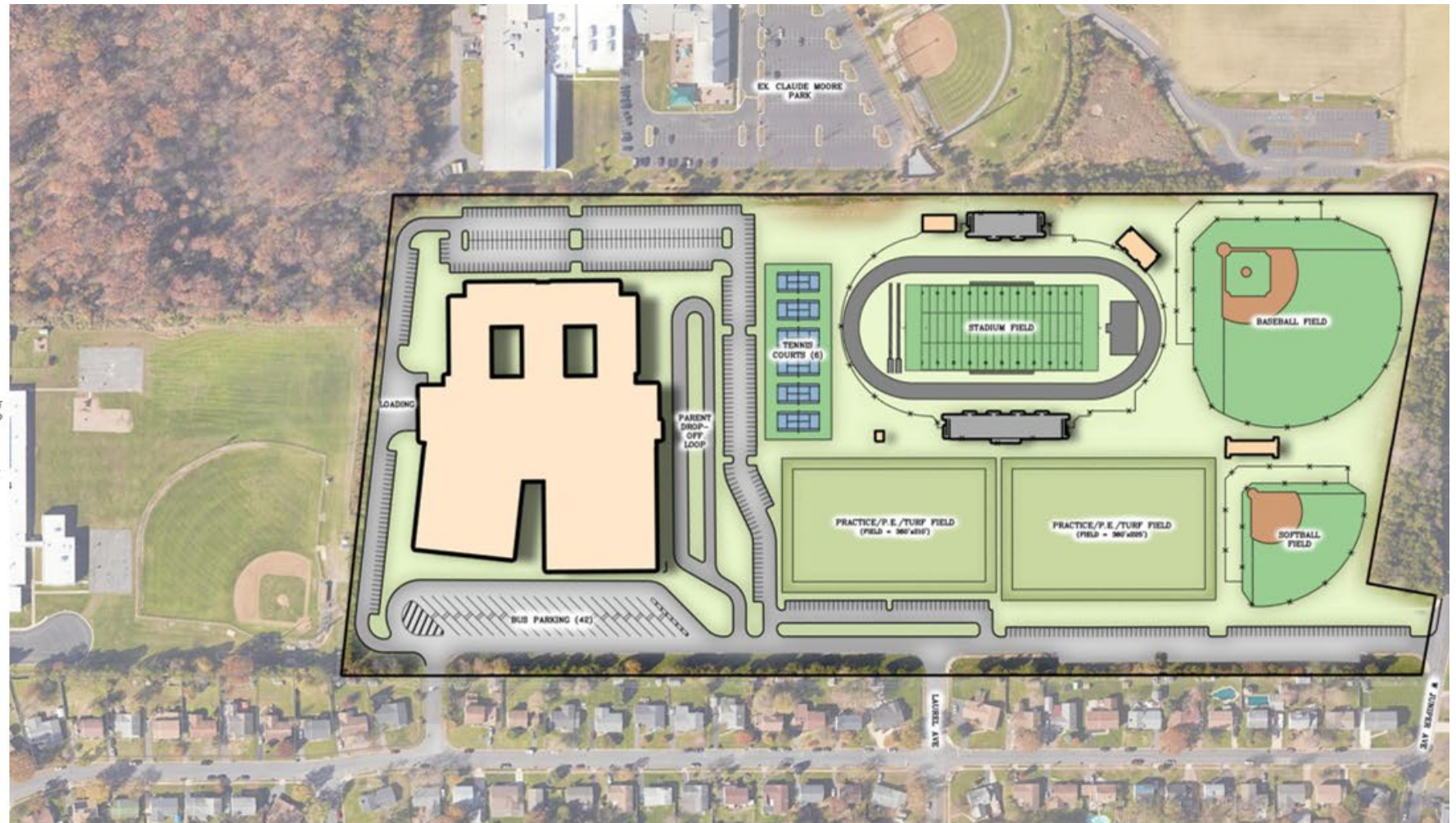

NEW BUILDING OPTION-2A PHASE 3



Park View High School

Capital Budget Community Information Meeting
June 23, 2022

© 2022. All rights reserved. Loudoun County Public Schools

Next Steps

Renovation vs Replacement Feasibility Study Process

- Perform comprehensive existing site and building analysis
- Develop multiple replacement and renovation options
- Receive feedback on preferred options
- Refine preferred options
- Develop preliminary schedules and cost estimate
- Finalize report
- Deliver recommendations to school board



Park View High School

Capital Budget Community Information Meeting
June 23, 2022

LCPS Capital Budgets Process

Month	LCPS Capital Budgets Process
June – October	Department of Support Services Meetings for Preparation of Superintendent’s Recommended CIP and CAPP Budgets, Including Six-Year Student Enrollment Projections
October	Superintendent and Cabinet Review of Recommended CIP and CAPP Budgets
Early November	Superintendent’s Recommended CIP and CAPP Budgets Presented to School Board
November - December	School Board Public Hearings and Work Sessions on CIP and CAPP Budgets
December	School Board Adoption of CIP and CAPP Budgets
February	County Administrator’s Proposed Fiscal Plan Presented to Board of Supervisors
February - April	Board of Supervisor Public Hearings and Work Sessions on Fiscal Plan
April	Board of Supervisors Adoption of Fiscal Plan

School Board Adopted FY 2023 - FY 2028 CIP & CAPP

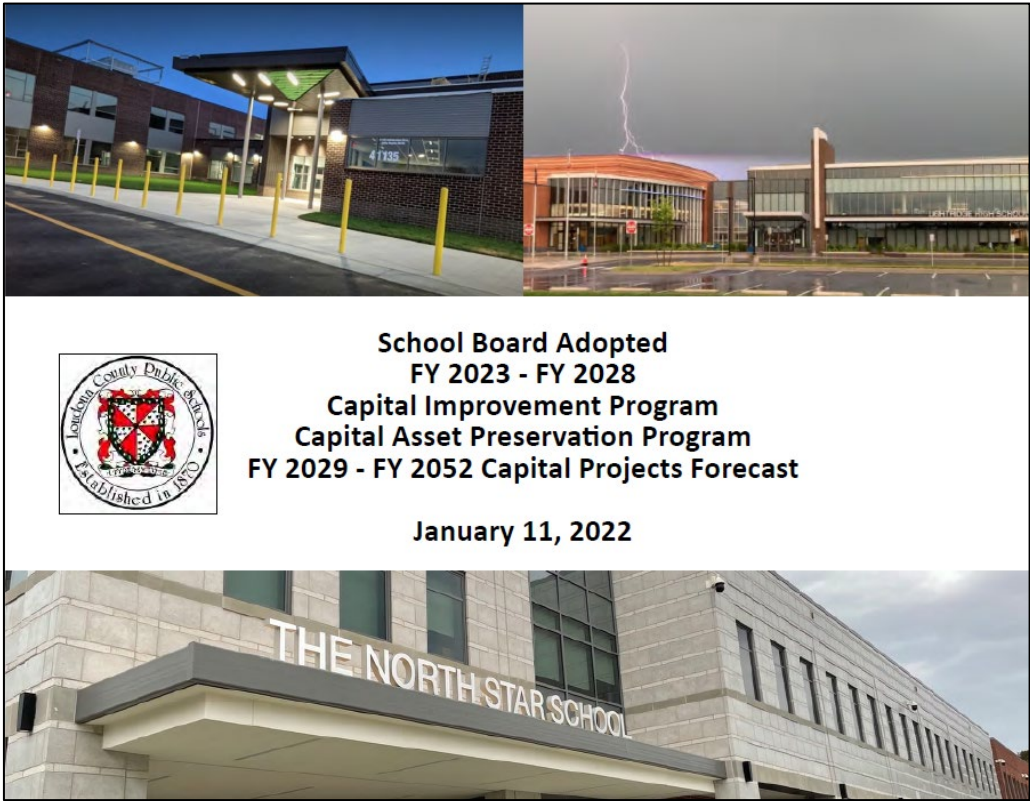

Addendum

Capital Budget Community Meeting on Future School Facility Projects - Eastern Loudoun Area Focus

STUDENT WELCOME CENTER



This project provides funding to design and construct an addition at Sterling Elementary School for a Student Welcome Center. The establishment of a Student Welcome Center in eastern Loudoun will provide more efficient and effective delivery of services to the County's limited English proficient public-school students. The Welcome Center will offer a centralized location in eastern Loudoun for various instructional program registration needs, as well as for instructional and/or pupil services support staff.

The addition to Sterling Elementary School, for the Welcome Center, will total 7500 square feet but will not increase the base capacity of the school. On-site parking will be expanded to accommodate the co-located uses.

Project Details	
Acres	N/A
Square Feet	7,500
Base Capacity	N/A
Election District	Sterling
School Planning District	Eastern Loudoun
Referendum Date	November 2020
School Year Opening	2023-2024

PROJECT	TASK	FUNDING	FY 2023				FY 2024				FY 2025				FY 2026				FY 2027				FY 2028			
			Q1	Q2	Q3	Q4	Q1	Q2	Q3	Q4	Q1	Q2	Q3	Q4	Q1	Q2	Q3	Q4	Q1	Q2	Q3	Q4	Q1	Q2	Q3	Q4
Student Welcome Center	Design	\$ 0.860																								
	Construction and FFE	\$ 6.850	CONSTRUCTION				OPEN																			
	Total Appropriations	\$ 7.710	\$ 6.850																							

SCHOOL SECURITY IMPROVEMENTS

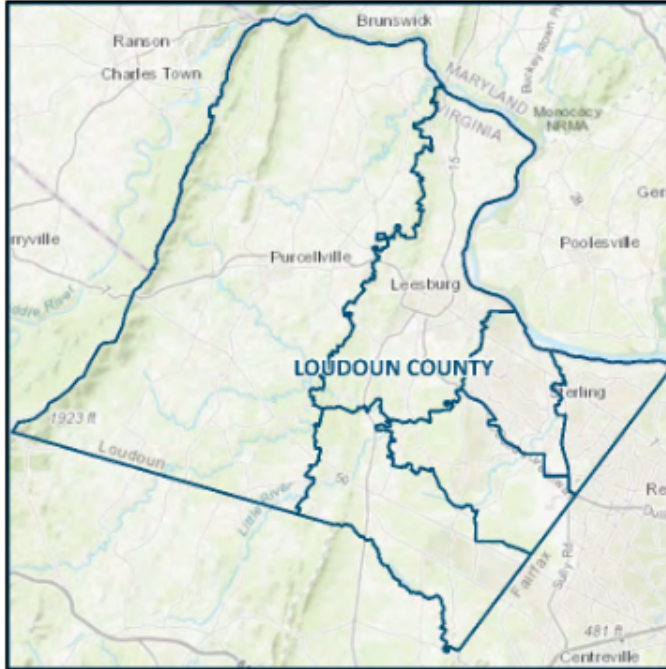

Prior appropriations were approved from FY 2019 - FY 2022, and additional appropriations are requested in FY 2023 and FY 2024, to provide secure vestibules, upgraded intrusion detection systems, and exterior door electronic access locks at schools throughout the County.

Funding will provide enhanced security at school campuses to include: door hardware, electronics and controls at building entries to manage visitor access, additional cameras and iPhones, modified office configurations, access deterrent measures, and interim secure vestibules to provide enhanced security until permanent work can be completed. Additional enhanced visitor management hardware, controls and access deterrent measures also need to be applied to other facilities that already have the necessary vestibule configuration. Significant interior modifications of office and media center spaces at nine (9) high schools are proposed to better align staff resources with enhanced entry security systems.

Project Details	
Election District	Countywide
LCPS Planning District	Countywide
Referendum Date	November 2017,2018,2020
School Year Opening	2021-2024

PROJECT	TASK	FUNDING	FY 2023				FY 2024				FY 2025				FY 2026				FY 2027				FY 2028			
			Q1	Q2	Q3	Q4	Q1	Q2	Q3	Q4	Q1	Q2	Q3	Q4	Q1	Q2	Q3	Q4	Q1	Q2	Q3	Q4	Q1	Q2	Q3	Q4
School Security Improvements	Exterior Doors	\$ 4.785	CONSTRUCTION																							
	Alarm Systems	\$ 2.940	CONSTRUCTION																							
	Secure Vestibules	\$ 85.279	CONSTRUCTION																							
	Total Appropriations	\$ 93.004	\$ 11.615				\$ 2.875																			

SCHOOL BUS REPLACEMENT AND ACQUISITION



This project provides funding for the replacement and acquisition of school buses on an annual basis.

In support of the 2020 Loudoun County School Board resolution on Climate Change, the Division of Transportation began an electric bus pilot program to explore ways to reduce our carbon footprint. LCPS school buses travel over 8 million miles each year and produce over 20 tons of carbon monoxide into the environment. With recent action on climate change and new alternative-fuel products on the market from school bus manufacturers, the LCPS pilot program is designed to test the viability of electric buses to serve our students' transportation needs.

Through a partnership with Dominion Energy, five electric buses have been placed into service and are based (charged) at Park View High School. As part of a 2nd phase of the pilot program, LCPS was recently awarded six (6) electric buses from the Virginia Department of

Environmental Quality, which will be based (charged) at Cardinal Ridge Elementary School and planned for operations in 2022. The pilot program and industry research and monitoring will inform a long-term transportation fleet strategy under development.

PROJECT	TASK	FUNDING	FY 2023				FY 2024				FY 2025				FY 2026				FY 2027				FY 2028			
			Q1	Q2	Q3	Q4	Q1	Q2	Q3	Q4	Q1	Q2	Q3	Q4	Q1	Q2	Q3	Q4	Q1	Q2	Q3	Q4	Q1	Q2	Q3	Q4
School Bus Replacement and Acquisition	Design																									
	Construction																									
	Total Appropriations	\$ 60.300	\$ 8.755				\$ 9.235				\$ 9.745				\$ 10.280				\$ 10.845				\$ 11.440			

LAND ACQUISITION FUND

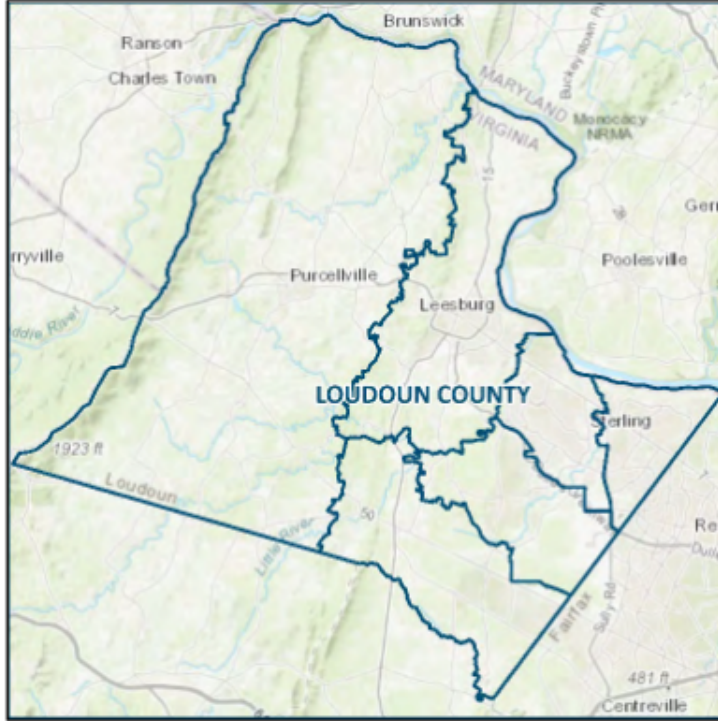

New school projects are located on sites acquired by proffered conveyance or purchase. When school sites cannot be obtained via proffered conveyance through an approved rezoning, LCPS requests funding to acquire suitable land to develop schools in locations that best serve the County's residents.

Funding is requested to acquire five (5) elementary schools, three (3) middle schools, two (2) high schools, and one (1) support facility during the 30-year CIP from FY 2023 to FY 2052.

Funding for land acquisition is planned up to three (3) years in advance of the commencement of design for school capital projects. Projected residential development in the County's 2019 Comprehensive Plan requires most of the land acquisition funding for new school sites in the first six-years of the CIP. This allows funds to be available early in the CIP to potentially acquire sites before available tracts of land are sold for other purposes.

Project Details	
Acres	TBD
Square Feet	N/A
Base Capacity	N/A
Election District	Countywide
LCPS Planning District	Countywide
Referendum Date	TBD
School Year Opening	N/A

PROJECT	TASK	FUNDING	FY 2023				FY 2024				FY 2025				FY 2026				FY 2027				FY 2028			
			Q1	Q2	Q3	Q4	Q1	Q2	Q3	Q4	Q1	Q2	Q3	Q4	Q1	Q2	Q3	Q4	Q1	Q2	Q3	Q4	Q1	Q2	Q3	Q4
Land Acquisition	Design																									
	Construction																									
	Total Appropriations	\$ 54.485	\$			-	\$			-	\$			2.475	\$			8.750	\$			29.510	\$			13.750

CAPITAL FACILITY RENEWALS AND ALTERATIONS

Prior Years	FY 2023- FY 2024	FY 2025 – FY 2028
Energy Conservation Projects	Energy Conservation Projects	Energy Conservation Projects
Staff Training Center Renewal	Staff Training Center Renewal	Eagle Ridge MS Classroom Addition
Elementary School Stage Access	Park View HS/W.O. Robey HS Addition and Improvements (Design only)	Farmwell Station MS Classroom Addition
Safety & Security Improvements	Safety & Security Improvements	Safety & Security Improvements
Potomac Falls HS Weight Room Expansion	High School Weight Room Expansions	Inclusive Playgrounds
Administrative Office Reconfigurations	Transportation Facility Asphalt Repairs	Transportation Facility Asphalt Repairs
Catoctin ES Addition	High School Baseball/Softball Press Boxes	High School Baseball/Softball Press Boxes
Briar Woods HS Classroom Addition	High School Tennis Court Lighting	High School Tennis Court Lighting
HVAC System Upgrades	Round Hill Center Renewal	Round Hill Center Renewal
Arcola ES Parking Expansion	School Walking Tracks	School Walking Tracks
Park View HS Ticket Booth and Concessions	Modular Classroom Removals	School Bus Washing Station
Waterford ES Modulares	High School Practice Field Turf and Lights	High School Practice Field Turf and Lights
Willard MS Modulares	Banneker ES Addition	Banneker ES Addition
	Fine Arts Storage Improvements	Fine Arts Storage Improvements
	River Bend MS Entrance	Waterford ES Addition
	Unified Communication Systems	Unified Communication Systems
	Privacy Space Conversions	
	Central Vehicle Maintenance/Western Support Center	

ENERGY CONSERVATION PROJECTS



The projects focus on energy conservation in all school buildings, to include:

- Replacing lighting on campus with LED fixtures
- Installing Solar Photo-voltaic arrays
- Replacing electrical transformers
- Recommissioning HVAC energy management systems
- Replacing plumbing fixtures with reduced flow fixtures
- Replacing major mechanical systems
- Applying roof coating and sealant

Funding for the projects are provided from FY 2021 – FY 2029. The focus of the planned work is to reduce utility costs at each school over the next 20 years.

Project Details	
Acres	N/A
Square Feet	N/A
Base Capacity	N/A
Election District	Countywide
LCPS Planning District	Countywide
Referendum Date	TBD
School Year Opening	Various

FINE ARTS STORAGE IMPROVEMENTS



This project provides funding to:

- Design and construct renovations and /or additions to middle schools (17) and high schools (17) to accommodate additional musical instrument storage space within school buildings. Middle School renovations/additions could provide up to 500 square feet of additional space for musical instrument storage at each school. High school renovations/additions could provide up to 900 square feet of additional space for musical instrument storage at each school.
- Design and construct a 900 square foot building for marching band storage, either attached or detached from the main school building as best suited for each site, adjacent to the designated outdoor marching band practice area at each high school.
- Provide for an outdoor marching band observation tower adjacent to each high schools' designated outdoor marching band practice area.

Project Details	
Acres	N/A
Square Feet	TBD
Base Capacity	N/A
Election District	Countywide
LCPS Planning District	Countywide
Referendum Date	TBD
School Year Opening	TBD

HIGH SCHOOL PRACTICE FIELDS

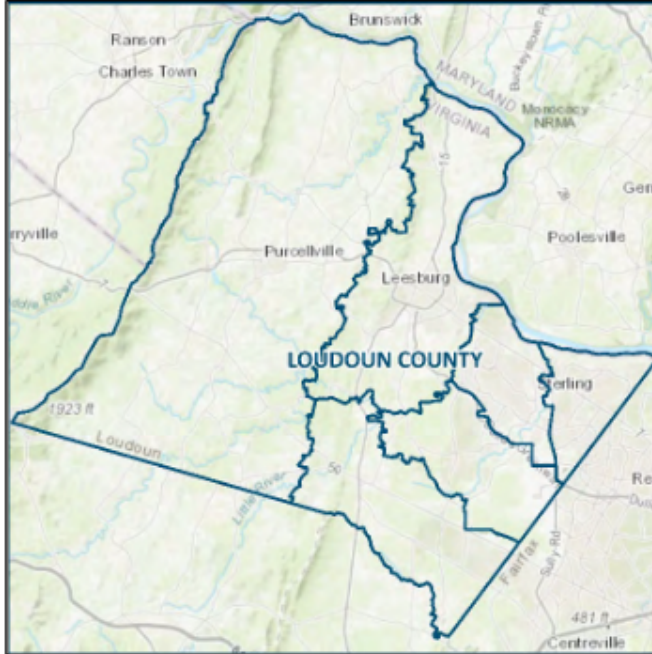

Funding will be provided to install athletic field lighting and synthetic turf to ensure all high schools in the County have two lighted, synthetic turf fields.

The installation of synthetic turf and lights will allow teams to extend the amount of time the fields can be in use for high school athletic teams for practices or matches. The additional high school fields will also be used for County Parks and Recreation athletic programs when the fields are not in use by the high schools.

The project will install synthetic turf at the nine (9) high schools in the County that do not already have a practice field with synthetic turf: Loudoun County High School, Broad Run High School, Potomac Falls High School, Heritage High School, Stone Bridge High School, Dominion High School, Briar Woods High School, Freedom High School, and Tuscarora High School. All high schools in the County will have athletic field lighting installed at one practice field per school.

Project Details	
Acres	N/A
Square Feet	N/A
Base Capacity	N/A
Election District	Countywide
LCPS Planning District	Countywide
Referendum Date	TBD
School Year Opening	Various

HIGH SCHOOL TENNIS COURT LIGHTING

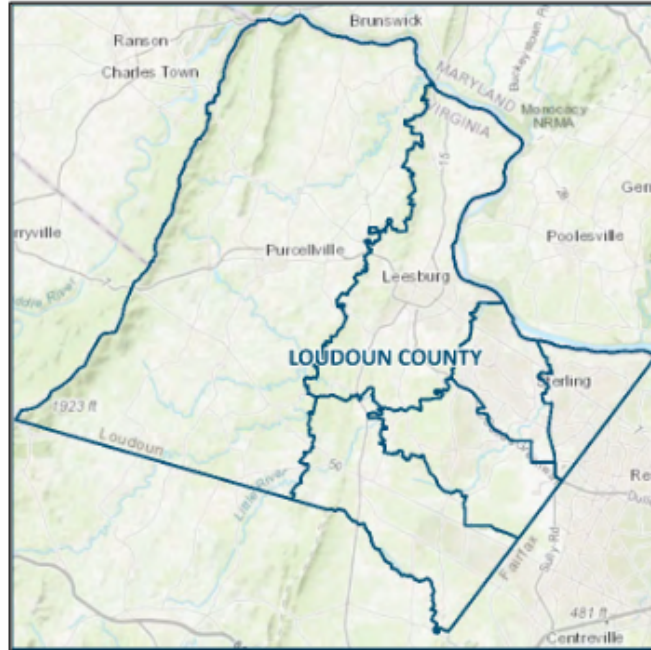

Beginning in FY 2023, funding is requested to install tennis court lights at each LCPS high school where lights do not currently exist. Lighting improvements will be completed over a three-year period. The installation of lights will allow teams to wait out weather delays, avoid the postponement of matches due to loss of light, and enable students to stay in school for the entire instruction day for regular season matches while still completing full length matches.

The fourteen (14) high schools where lights will be installed include: Briar Woods High School, Broad Run High School, Dominion High School, Freedom High School, Heritage High School, John Champe High School, Loudoun County High School, Loudoun Valley High School, Potomac Falls High School, Riverside High School, Rock Ridge High School, Stone Bridge High School, Tuscarora High School, and Woodgrove High School.

Project Details	
Acres	N/A
Square Feet	N/A
Base Capacity	N/A
Election District	Countywide
LCPS Planning District	Countywide
Referendum Date	TBD
School Year Opening	2023-2024 2024-2025 2025-2026

HIGH SCHOOL WEIGHT ROOM EXPANSIONS

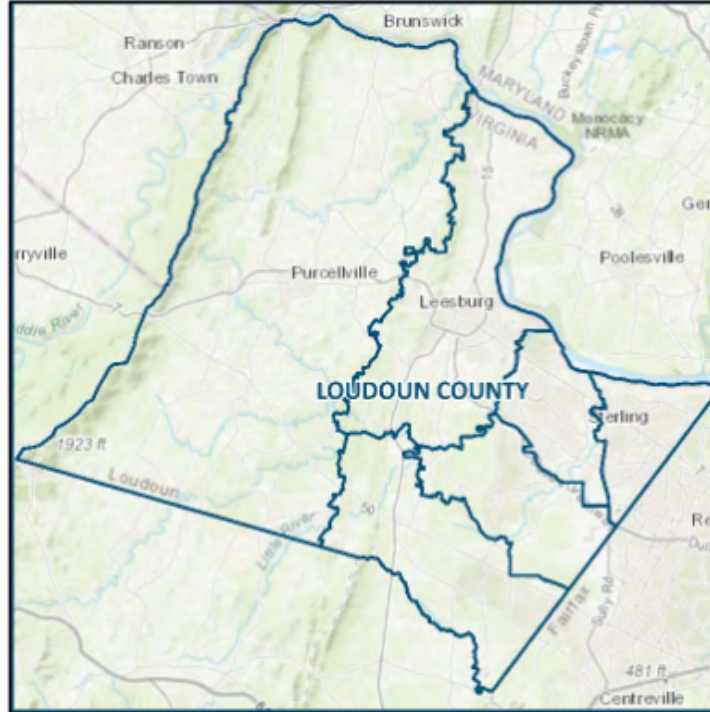

Funding will provide for the expansion of the existing weight rooms at Dominion High School, Heritage High School, and Potomac Falls High School. The weight room expansions will be completed over a three-year period, beginning with Potomac Falls High School in FY 2022.

LCPS collected \$125,000 in cash proffers from the Sterling Meadow rezoning (ZMAP-2019-0007) towards the weight room expansion at Potomac Falls High School.

The expansions are proposed to accommodate increased participation and team/sport opportunities at the high school level. Current prototype high schools have additional space to address the increased need.

Project Details	
Acres	N/A
Square Feet	TBD
Base Capacity	N/A
Election District	Algonkian, Catoclin, Sterling
LCPS Planning District	Central, Eastern
Referendum Date	TBD
School Year Opening	2022-2023 2023-2024 2024-2025

MODULAR CLASSROOM REMOVALS

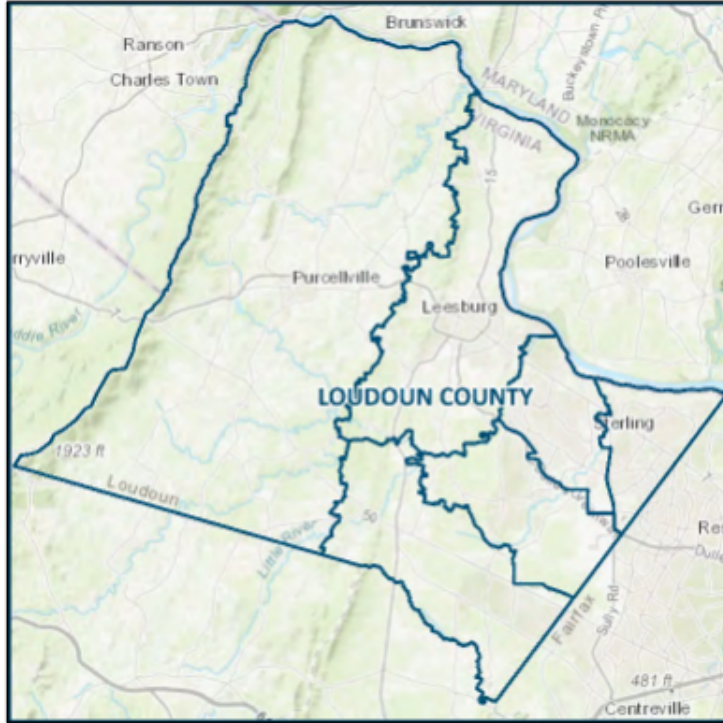

This project provides funding to remove modular classrooms at schools where the useful life of the modular has been met or exceeded, or where continued maintenance of the modular is cost prohibitive.

Where applicable and practical, every intent will be made to provide additional space at the school to make up for the loss of modular classrooms.

Project Details	
Acres	N/A
Square Feet	N/A
Base Capacity	N/A
Election District	Countywide
LCPS Planning District	Countywide
Referendum Date	TBD
School Year Opening	TBD

PRIVACY SPACE CONVERSIONS

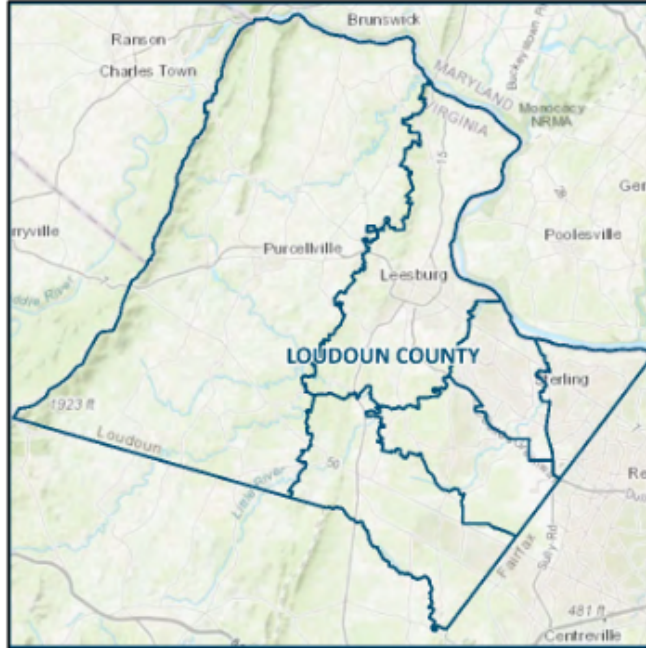

This project provides funding to:

- Continue to expand access to shower rooms, locker rooms, and other private spaces through renovations to locker rooms to provide private shower and changing areas in middle schools and high schools.
- Continue to expand access through renovations to restrooms to provide single occupant, private restrooms, to accommodate students and staff that desire to use private restroom facilities in each school facility.

Staff continues to establish recommendations in consultation with school principals and professional design consultants. The scope of work may vary by school and may be revised as lessons are learned at the school level.

In accordance with School Board action, improvements must be complete by 2026.

Project Details	
Acres	N/A
Square Feet	TBD
Base Capacity	N/A
Election District	Countywide
LCPS Planning District	Countywide
Referendum Date	TBD
School Year Opening	TBD

RIVER BEND MIDDLE SCHOOL ENTRANCE/DRIVEWAY

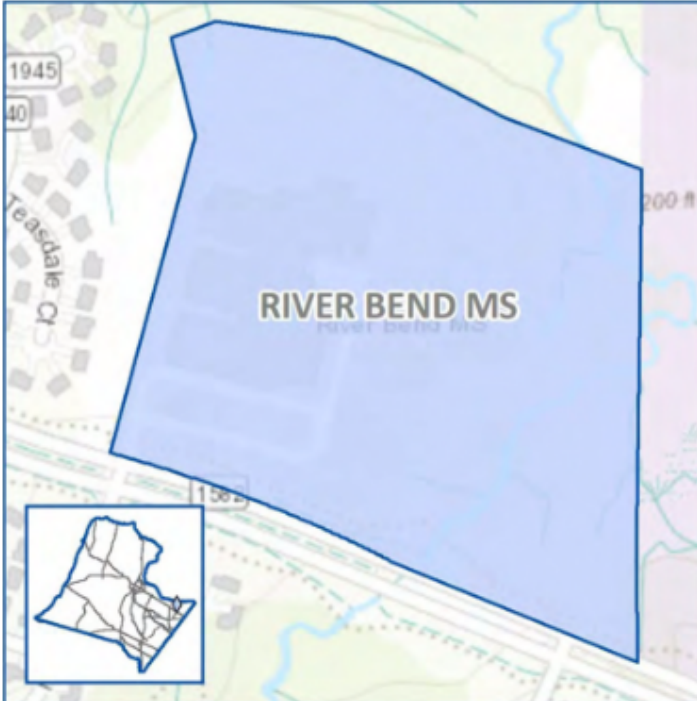

Access to River Bend Middle School is currently provided via one driveway from Algonkian Parkway. This driveway is shared by both buses and cars during arrival and dismissal. A second entrance would be provided from Algonkian Parkway to separate bus and car traffic making access safer and more efficient.

Project Details	
Acres	N/A
Square Feet	N/A
Base Capacity	N/A
Election District	Algonkian
LCPS Planning District	Eastern Loudoun
Referendum Date	TBD
School Year Opening	TBD

SAFETY AND SECURITY IMPROVEMENTS

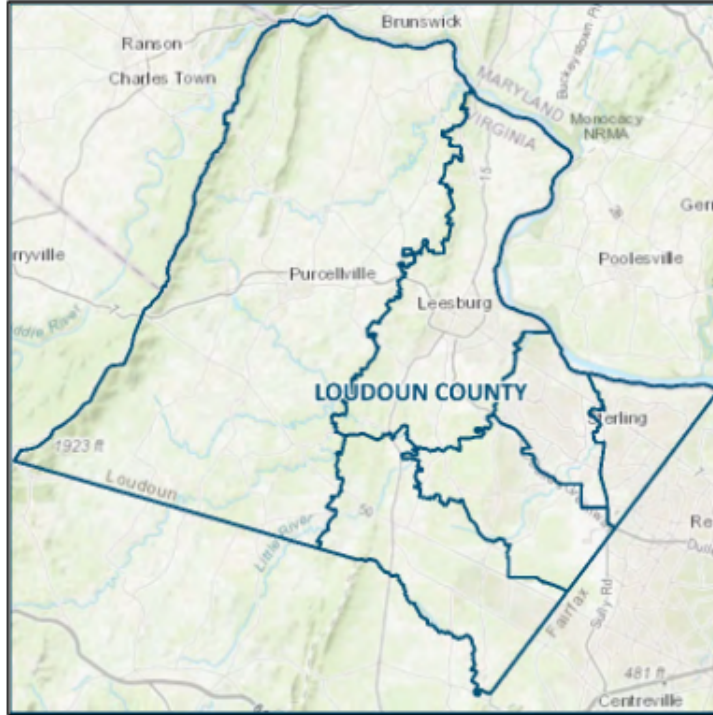

This project provides funding for closed circuit television (CCTV) improvements, security cameras, and servers at schools throughout the County. This funding is being provided in addition to planned appropriations for the School Security Improvements project in the CIP, which provides for external door access improvements and secure vestibules at schools throughout the County.

The following schools will be addressed in FY 2023:

Elementary Schools - Ashburn, Ball's Bluff, Dominion Trail, Evergreen Mill, Hillside, Lovettsville, Lowes Island, Mill Run, Potowmack, Sanders Corner, Sugarland.

Middle Schools - Eagle Ridge, J.L. Simpson, Seneca Ridge.

High Schools – Dominion, Heritage, Rock Ridge.

Project Details	
Acres	N/A
Square Feet	N/A
Base Capacity	N/A
Election District	Countywide
LCPS Planning District	Countywide
Referendum Date	N/A
School Year Opening	Various

SCHOOL WALKING TRACKS

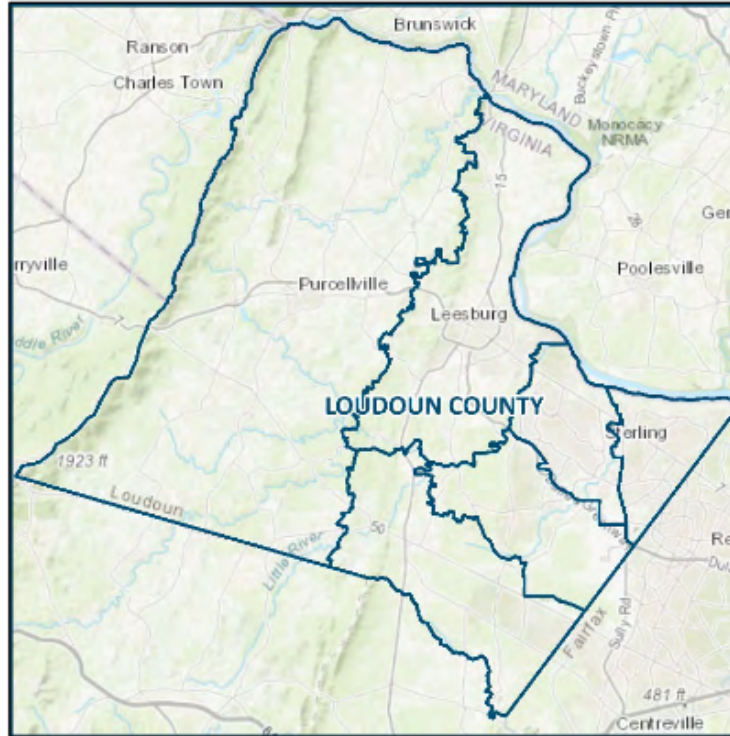

The construction of walking tracks at fifteen (15) schools are recommended to enhance the physical education instructional program at schools that currently do not have a track.

Elementary Schools (12) –Aldie, Algonkian, Countryside, Guilford, John W. Tolbert Jr., Leesburg, Lincoln, Lucketts, Rolling Ridge, Rosa Lee Carter, Sterling, Waterford.

Middle Schools (3) - Seneca Ridge, Smart's Mill, Stone Hill.

The scope of the project may be reduced depending on the allowable use of school cash proffers, as determined by the Town of Leesburg, to provide for school walking tracks at schools located within the Town limits.

Project Details	
Acres	N/A
Square Feet	N/A
Base Capacity	N/A
Election District	Countywide
LCPS Planning District	Countywide
Referendum Date	TBD
School Year Opening	Various

UNIFIED COMMUNICATION SYSTEMS

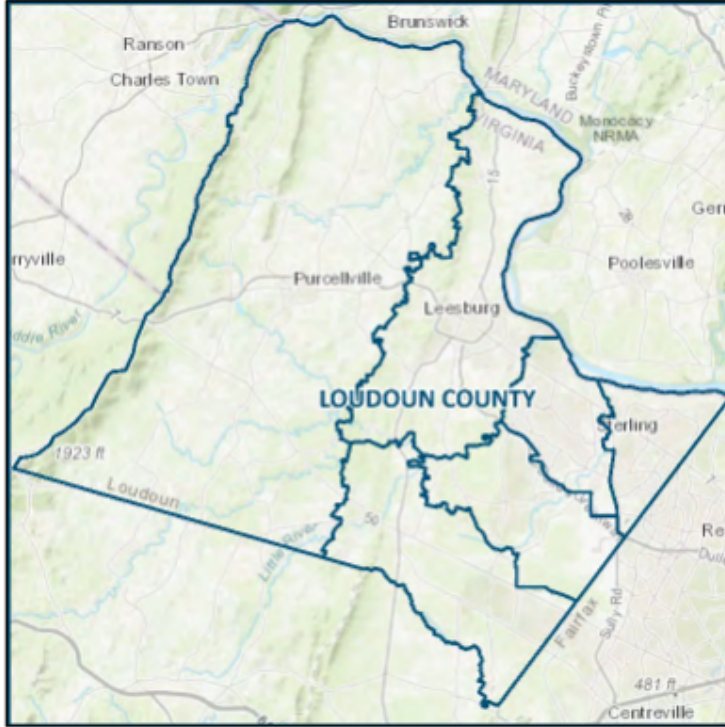

Unified Communication Systems (UC) are the modern replacement for school intercom, public address, paging, and telephone systems. They create a single integrated system to support school communications and safety. UC systems are IP-based and require new cabling as they do not utilize existing speaker or telephone cabling.

Many of the current systems in LCPS are over 20 years old with the oldest equipment still in use from the 1970's. Funding is provided to establish a yearly refresh cycle for the legacy system equipment and to provide additional data cabling to support network-connected UC components.

Project Details	
Acres	N/A
Square Feet	N/A
Base Capacity	N/A
Election District	Countywide
LCPS Planning District	Countywide
Referendum Date	TBD
School Year Opening	TBD



Capital Budget Community Meeting on Future School Facility Projects - Eastern Loudoun Area Focus

June 23, 2022
