



Banneker Elementary School Renovation & Addition

May 17, 2023

Kevin L. Lewis
Chief Operations Officer

Banneker Elementary School

- **Introductions**
- **Project Overview & Next Steps**
- **Questions & Answers**



Banneker Elementary School

Banneker Elementary School is the only remaining African American school in Loudoun County still operating as a school.



Banneker Elementary School Renovation & Addition



School Board Adopted
FY 2024 - FY 2029
Capital Improvement Program
Capital Asset Preservation Program
FY 2030 - FY 2053
Capital Projects Forecast

December 13, 2022

BANNEKER ELEMENTARY SCHOOL RENOVATION & ADDITION

Location: 35231 Snake Hill Rd, Middleburg		Site Acreage: 19.22
LCPS Planning District: Western Loudoun	2011 Election District: Blue Ridge	2022 Election District: Little River
Project Category: Other Capital Project	School Year Opening: 2026-2027	

Project Description:

This project provides funding to renovate and construct an estimated 38,000 square foot addition that will include a multipurpose room, five (5) classrooms, and other ancillary spaces. The multipurpose room will provide program space as a gymnasium and auditorium with associated storage and office space. The five-classroom addition will accommodate kindergarten classroom space; the project will also provide additional restrooms in the building. Renovation work will include the cafeteria, kitchen, and office areas. The project will also remove all modular classrooms from the school site.



SCAN ME

School Board Adopted FY2024 – FY 2029 CIP, Page 19



Project Description

This project plans for the renovation of and addition to the historic Banneker Elementary School. The scope will include phased construction to maintain the current school operations throughout construction.

The building and site hold important historical significance in the community. LCPS aims to preserve and restore the exterior of the original building and to renovate the interior maintaining footprints of original classrooms. The addition will complement the original building and uphold its importance.



For 2023-2024 School Year

- Remove 2 Existing Modular Classrooms
- Place 4 New Modular Classrooms

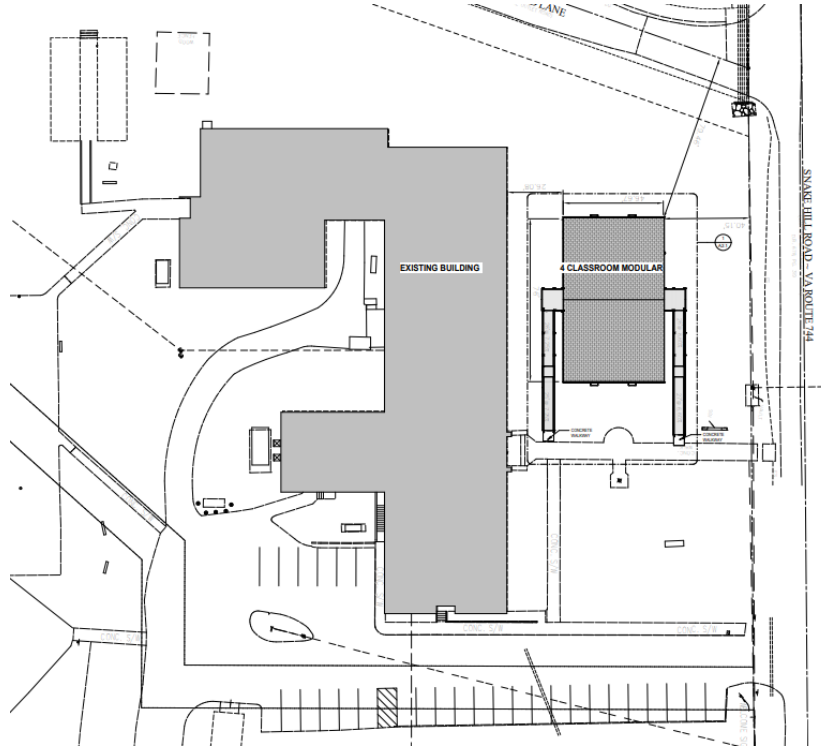

Banneker Elementary School

Modular Classrooms



For 2026-2027 School Year Opening

- Renovation & Addition Project
 - Multipurpose Room Addition
Provides Gym/Auditorium Space
 - Five Classroom Addition
for 350-Student Capacity School
 - Additional Restrooms
 - Renovation of Cafeteria/Kitchen
 - Renovation of Office Areas
 - Removal of All Modular Classrooms
- Design Funding, July 2023
- Construction Funding, July 2024
- Formation of Banneker ES Advisory Group

Banneker Elementary School Renovation/ Addition Project



Formation of Banneker ES Advisory Group

- 4 – 5 Stakeholder Members
- Community Representation
 - Banneker Elementary Parent/Staff
 - Banneker Alumni (1948-1968 Period)
 - St. Louis Community Resident
 - Black History Committee
- Selection
 - Letter of Interest
 - LCPSPLAN@LCPS.ORG or
 - LCPS, Department of Support Services
960 Sycolin Rd SE, Suite 110
Leesburg, VA 20175

Banneker Elementary School

Advisory Group





BANNEKER ELEMENTARY SCHOOL

FEASIBILITY STUDY
OCTOBER 7, 2022

OPTION A - RENOVATION / ADDITION

HEAVY RENOVATION = 23,000 SF
NEW CONSTRUCTION = 38,000 SF
TOTAL = 61,000 SF



- NEW CONSTRUCTION
- HEAVY RENOVATION
- EASEMENT
- EXISTING TO REMAIN
- - - - TO BE DEMOLISHED
- ▲ ENTRY

OPTION A (RENOVATION / ADDITION)

- HEAVY RENOVATION OF EXISTING BUILDING
- NEW BUILDING ADDITIONS
- NEW MAIN ENTRY AT THE EAST
- BUS DROP-OFF ON THE SOUTH (8 BUSES)
- EXISTING SOFTBALL FIELD TO REMAIN
- +/- 55 PARKING SPACES
- STUDENT CAPACITY= 350

OPTION B - REPLACEMENT AND DEMOLITION

NEW CONSTRUCTION = 59,000 SF



OPTION B (REPLACEMENT AND DEMOLITION)

- NEW ELEMENTARY SCHOOL
- DEMOLITION OF EXISTING SCHOOL
- NEW MAIN ENTRY AT THE NORTH
- BUS DROP-OFF ON THE EAST (8 BUSES)
- NEW SOFTBALL FIELD AND TRACK
- +/- 60 PARKING SPACES
- STUDENT CAPACITY= 350

OPTION C - REPLACEMENT AND RETENTION

NEW CONSTRUCTION = 59,000 SF



OPTION C (REPLACEMENT AND RETENTION)

- NEW ELEMENTARY SCHOOL
- EXISTING SCHOOL TO REMAIN
- NEW MAIN ENTRY AT THE NORTH
- BUS DROP-OFF ON THE EAST (8 BUSES)
- EXISTING SOFTBALL FIELD TO REMAIN
- +/- 60 PARKING SPACES
- CAPACITY= 350



Preserving & Recognizing Loudoun's History

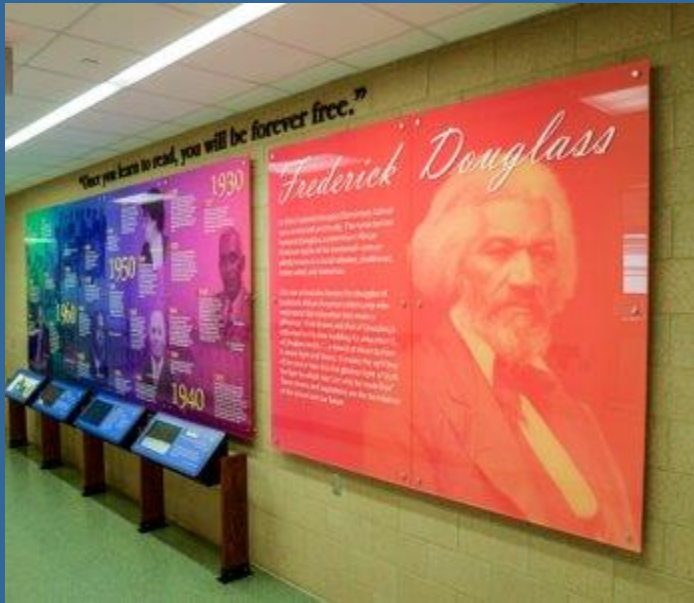

Frederick Douglass Elementary School

- **Frederick Douglass Elementary School, Timeline**
- **Douglass High School, Renovation and Commemorative Efforts Telling Story of School**
- **Arcola Slave Quarters, Future Learning Opportunity Adjacent to Elaine E. Thompson Elementary School**
- **Waterford Second Street School, Living History and Interactive Program**
- **Oatlands History Project, The Enslaved Community Database**



Next Steps

- Formation of Banneker ES Advisory Group, May-June 2023
- Banneker ES Project - Request for Proposals (RFP), June 2023
- Banneker ES Project - Design Funding, July 2023
- Banneker ES Project - Architect Selection, July-August 2023
- Banneker ES Project - Architect Contract Award, September 2023



Questions?





Banneker Elementary School Renovation & Addition

May 17, 2023

Kevin L. Lewis
Chief Operations Officer